

# MV 系列 機械閥 – MV 150

作動規格表與訂購稱呼說明

CHELIC PNEUMATIC

## 內部結構圖

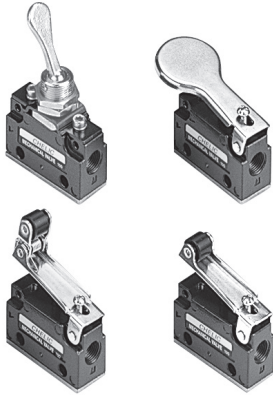

● MV-15S-01 (橫向配管/基本型)

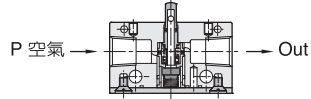

● MV-15B-01 (底部配管/基本型)

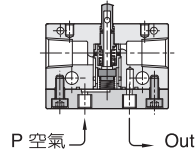

## 規格表

項目	機種	MV-15S	MV-15B	MV-15F
使用流體		空氣		
使用壓力範圍	Kgf/cm <sup>2</sup> (Kpa)	1~9 (100~900)		
使用溫度	°C	0~60°C		
位置數		三口二位置		
閥仕樣		常閉型		
有效斷面積	mm <sup>2</sup> (CV)	7(0.39)		
接管口徑	Rc(PT)	Rc 1/8 (橫向配管)	M5x0.8p (底部配管)	Rc 1/8 (橫向配管)
潤滑		自由供給方式		

MV  
控制閥

HVL  
手動閥

HVM  
手動閥

HVT  
小型手動閥

QE  
快速排氣閥

FVA  
腳踏閥

FVS  
腳踏閥

## 訂購稱呼代號

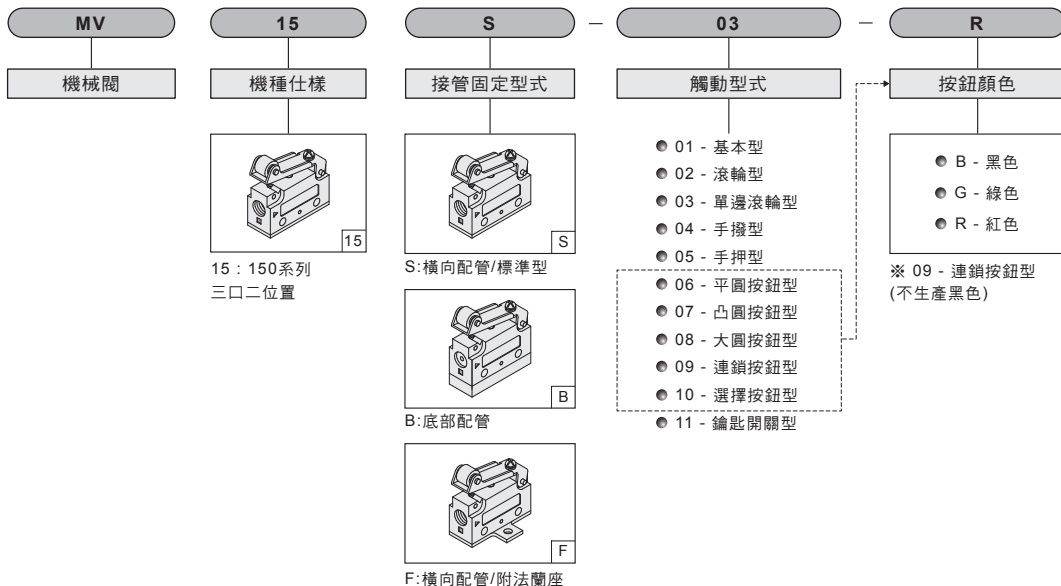

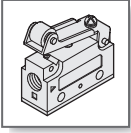

# MV 系列 機械閥 – MV 150

外觀圖形尺寸

氣立可空氣壓設備

## ◉ MV-15-S-01 基本型

S: 橫向配管 / 標準型

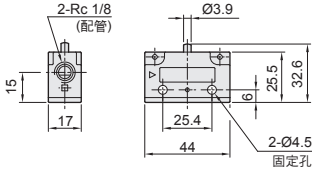

## ◉ MV-15-B-01 基本型

B: 底部配管

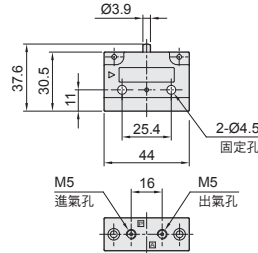

## ◉ MV-15-F-01

F: 附法蘭座

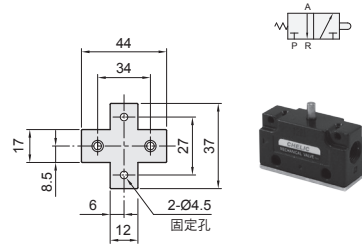

## ◉ MV-15-S-02 基本型

S: 橫向配管 / 標準型

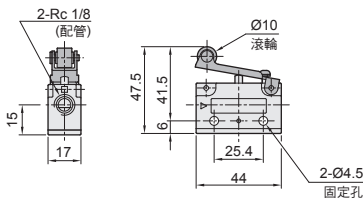

## ◉ MV-15-B-02 基本型

B: 底部配管

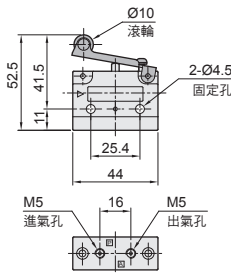

## ◉ MV-15-F-02

F: 附法蘭座

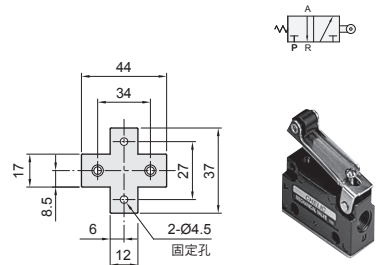

## ◉ MV-15-S-03 基本型

S: 橫向配管 / 標準型

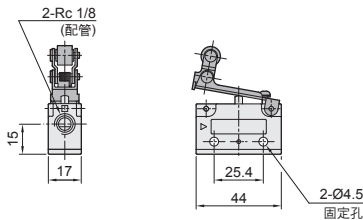

## ◉ MV-15-B-03 基本型

B: 底部配管

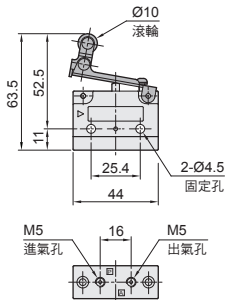

## ◉ MV-15-F-03

F: 附法蘭座

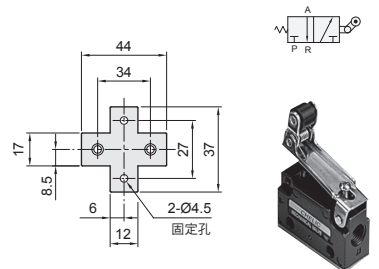

## ◉ MV-15-S-04 基本型

S: 橫向配管 / 標準型

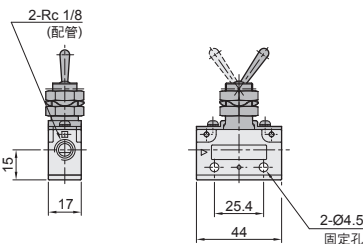

## ◉ MV-15-B-04 基本型

B: 底部配管

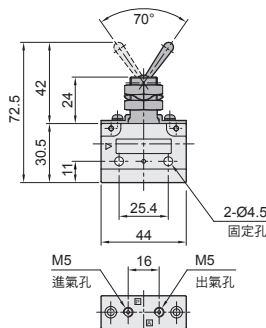

## ◉ MV-15-F-04

F: 附法蘭座

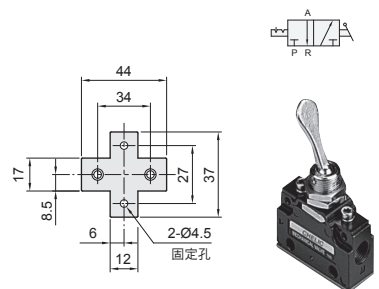

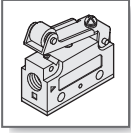

# MV 系列 機械閥 – MV 150

外觀圖形尺寸

CHELIC PNEUMATIC

## ◉ MV-15-[S]-[05] 手押型

S: 橫向配管 / 標準型

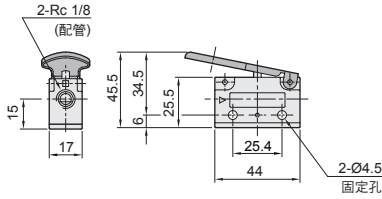

## ◉ MV-15-[B]-[05] 手押型

B: 底部配管

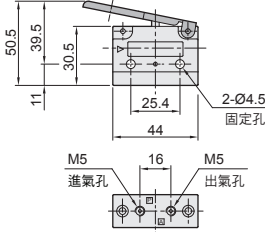

## ◉ MV-15-[F]-[05]

F: 附法蘭座

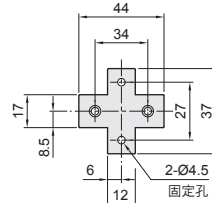

MV  
控制閥

## ◉ MV-15-[S]-[06] 平圓型

S: 橫向配管 / 標準型

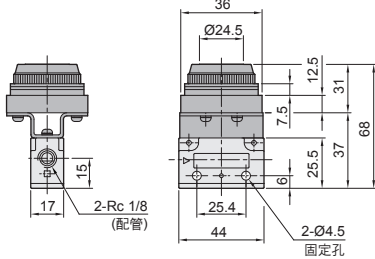

## ◉ MV-15-[B]-[06] 平圓型

B: 底部配管

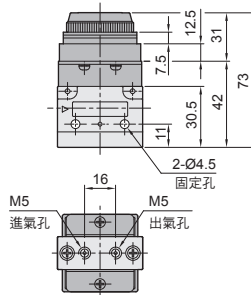

## ◉ MV-15-[F]-[06]

F: 附法蘭座

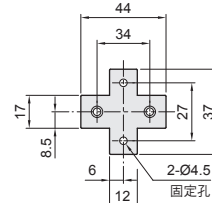

HVL  
手動閥

HVM  
手動閥

HVT  
小型手動閥

QE  
快速排氣閥

FVA  
腳踏閥

FVS  
腳踏閥

● 固定孔尺寸

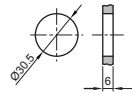

## ◉ MV-15-[S]-[07] 凸圓型

S: 橫向配管 / 標準型

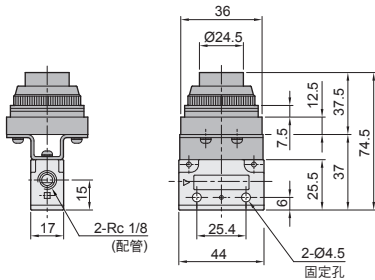

## ◉ MV-15-[B]-[07] 凸圓型

B: 底部配管

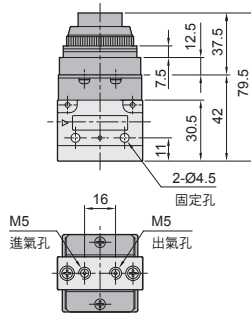

## ◉ MV-15-[F]-[07]

F: 附法蘭座

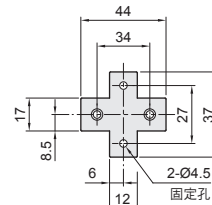

● 固定孔尺寸

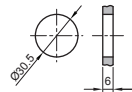

## ◉ MV-15-[S]-[08] 大圓型

S: 橫向配管 / 標準型

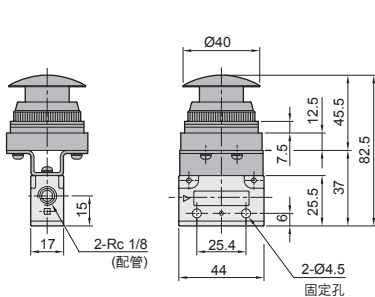

## ◉ MV-15-[B]-[08] 大圓型

B: 底部配管

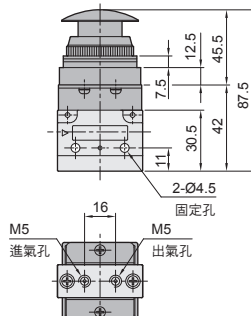

## ◉ MV-15-[F]-[08]

F: 附法蘭座

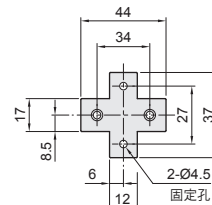

● 固定孔尺寸

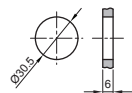

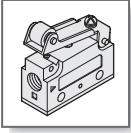

# MV 系列 機械閥 – MV 150

外觀圖形尺寸

氣立可空氣壓設備

● MV-15-**S**-**09** 連鎖型 / 押入定位  
S: 橫向配管 / 標準型

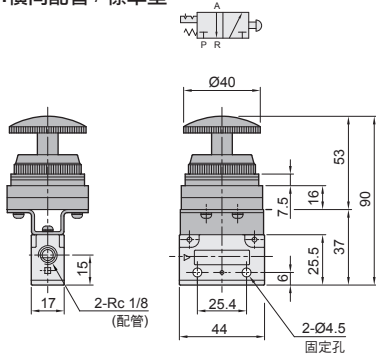

● MV-15-**B**-**09** 連鎖型 / 押入定位  
B: 底部配管

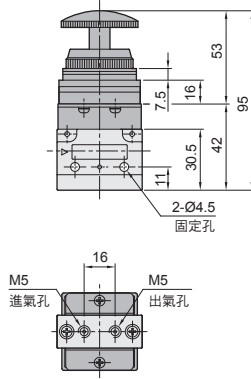

● MV-15-**F**-**09**  
F: 附法蘭座

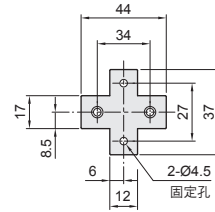

● MV-15-**S**-**10** 選擇型 / 旋轉定位  
S: 橫向配管 / 標準型

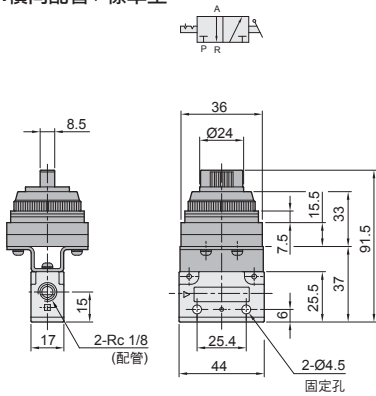

● MV-15-**B**-**10** 選擇型 / 旋轉定位  
B: 底部配管

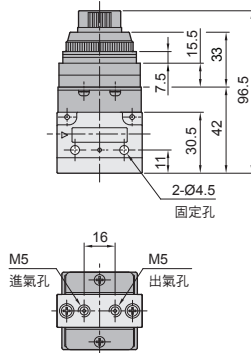

● MV-15-**F**-**10**  
F: 附法蘭座

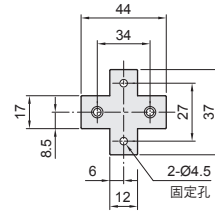

● MV-15-**S**-**11** 鑰匙型 / 旋轉定位  
S: 橫向配管 / 標準型

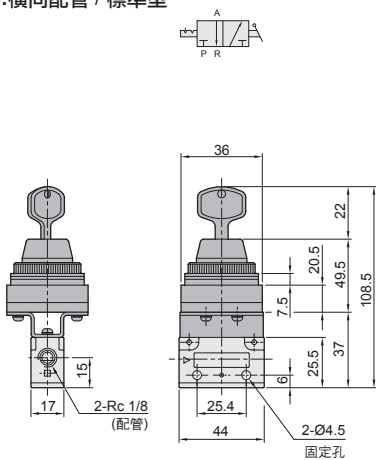

● MV-15-**B**-**11** 鑰匙型 / 旋轉定位  
B: 底部配管

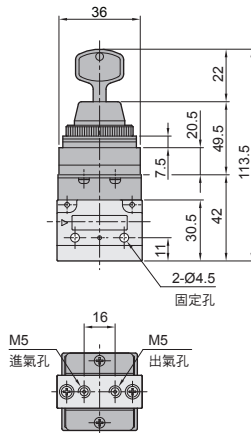

● MV-15-**F**-**11**  
F: 附法蘭座

